

# “Dai-Flow” Full Flow Air Coupling

## Dai-Flow Coupling

“ ” coupling solves the common problems with current air coupling and addresses the major issues of efficiency and safety. Tested in Australian, American and Japanese industry for the past 3 years we are pleased to identify the below benefits.

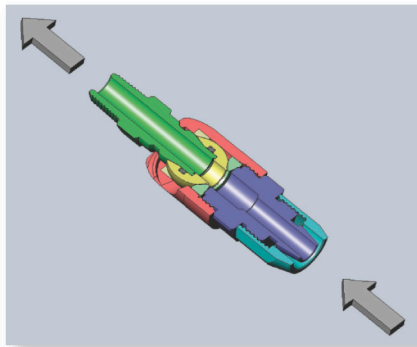

- Full-bore flow when coupling connected - NO valve to interrupt flow
- Safety lock connection. No accidental disconnection
- Purge function to discharge downstream hose - No hose lash
- Tough and durable to withstand the rigors of typical industrial use
- Slim and lightweight. Overall diameter at widest point
- Mechanically simple design - total 4 components

Body Material	Steel (Aluminum - only Aluminum type)
Max. Pressure	1.5 MPa
Burst Pressure	2.0 MPa
Sealing material	NBR
Temperature range in use	-5℃ ~ +60℃

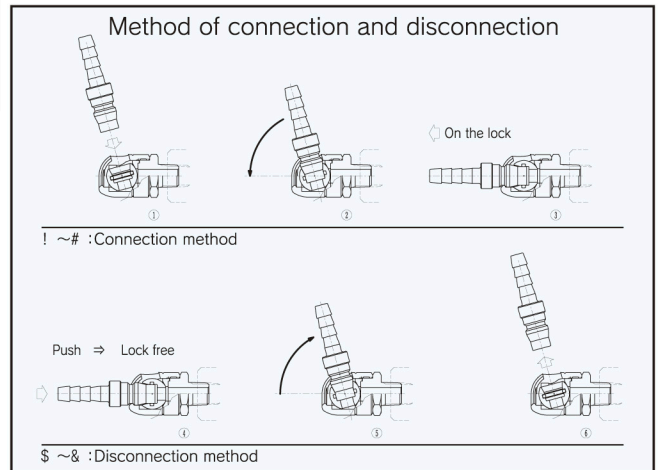

Body Material : Aluminum

### Male thread Socket

Model	Thread	A	φ F	H	Weight(g)
DF02M (AL)	R1/4	51	7.5	22	44
DF03M (AL)	R3/8	52	8	22	47
DF04M (AL)	R1/2	54	13	22	51
DF02M	R1/4	51	7.5	22	94
DF03M	R3/8	63	8	22	102
DF04M	R1/2	64	13	22	118

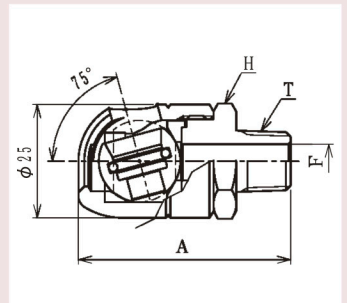

Body Material : Aluminum

### Nut Connection (For polyurethane Hose) Socket

Model	Hose Size	A	φ F	H1	F 2	Weight(g)
DF65 (AL)	6.5×10.0	55	5.7	22	16	50
DF80 (AL)	8.0×12.0	58	6.5	22	19	54
DF85 (AL)	8.5×12.5	58	6.5	22	19	54
DF65	6.5×10.0	76	5.7	19	16	120
DF80	8.0×12.0	78.5	6.5	19	19	134
DF85	8.5×12.5	78.5	6.5	19	19	134

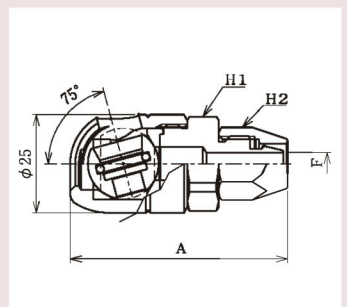

Body Material : Steel

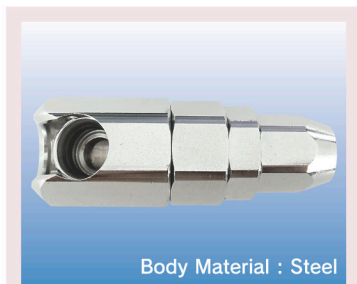

Body Material : Steel